

Spare Parts and Fittings

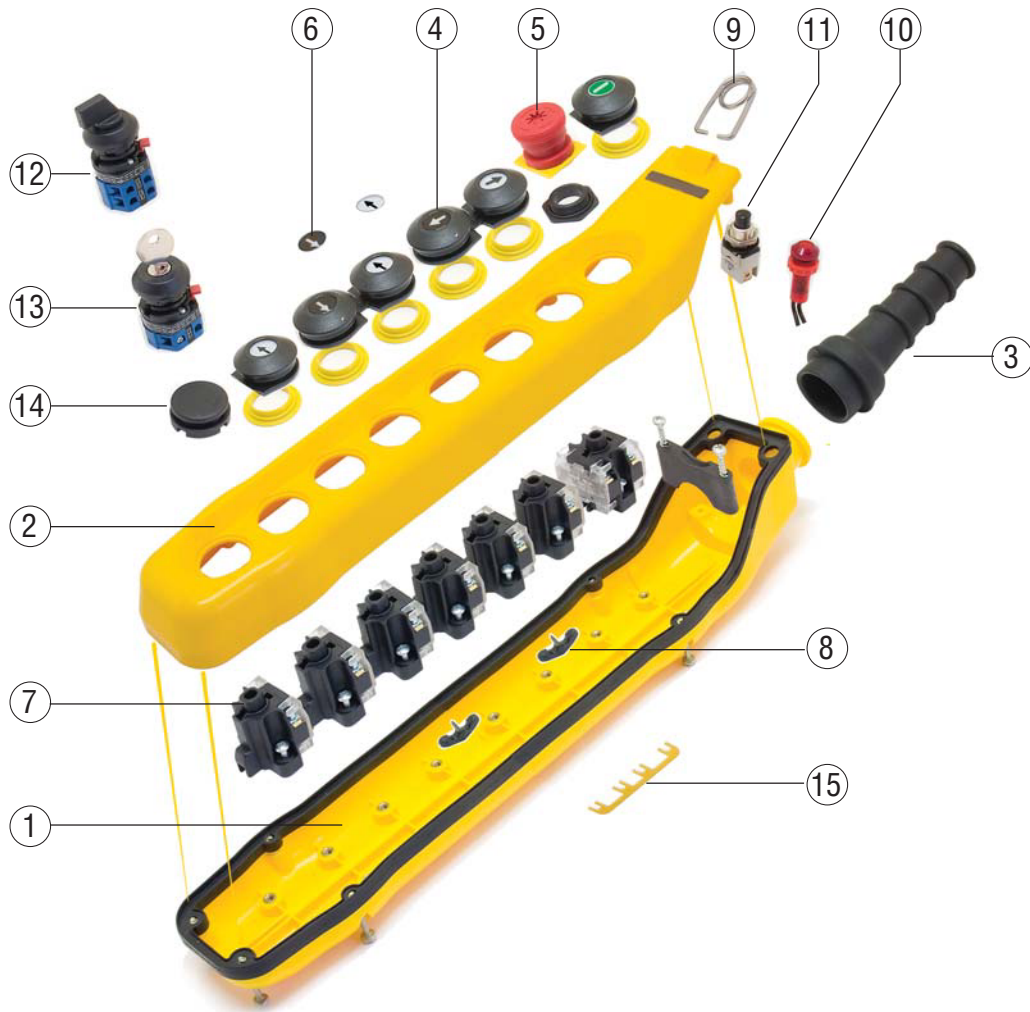

Pos. Code	Description
Spare parts	
1	<i>D LA02FON</i> Bottom for 2 buttons station <i>D LA04FON</i> Bottom for 4 buttons station <i>D LA06FON</i> Bottom for 6 buttons station <i>D LA08FON</i> Bottom for 8 buttons station <i>D LA10FON</i> Bottom for 10 buttons station <i>D LA12FON</i> Bottom for 12 buttons station with rubber gasket string wire clamp screws
2	<i>D LA02COP</i> Cover for 2 buttons station <i>D LA04COP</i> Cover for 4 buttons station <i>D LA06COP</i> Cover for 6 buttons station <i>D LA08COP</i> Cover for 8 buttons station <i>D LA10COP</i> Cover for 10 buttons station <i>D LA12COP</i> Cover for 12 buttons station
3	<i>D LAMC</i> 2-4 buttons pendant station rubber sleeve <i>D LAML</i> 6-12 buttons pendant station rubber sleeve
4	<i>D LAGUA2</i> Rubber gasket for 2 push-buttons with ring
5	<i>D LAEM</i> Mushroom head emergency stop button (without push-button element)
6	<i>D LASXX</i> Buttons with international symbols

Pos. Code	Description
Spare Parts	
7	<i>D MK10</i> 1NO push-button element <i>D MK01</i> 1NC push-button element <i>D MK11</i> 1NO + 1NC push-button element <i>D MK20CC</i> 2NO push-button element (simultaneous) <i>D MK20PR</i> 2NO push-button element (progressive) <i>D MK02CC</i> 2NC push-button element (simultaneous)
8	<i>D PKBLMEC</i> Mechanical interlock
9	<i>D LAGAN</i> Suspension hanger
Fittings	
10	<i>D LAPL</i> Pilot lamp
11	<i>D LABZ</i> 1NO push-button
12	<i>D LALS</i> Lever selector 0-1 <i>D LALS3</i> Lever selector 0-1-2
13	<i>D LAKS</i> Key selector 0-1 <i>D LAKS3</i> Key selector 0-1-2
14	<i>D LACL</i> Closure element with rubber gasket
15	<i>D LACC2SQ</i> 2 pins bridge connection 90° <i>D LACC4</i> 4 pins bridge connection 90°